

USE WITH CAUTION
 THIS IS A PUBLIC WORKS DEPARTMENT
 WORKING COPY OF AN OFFICIAL MAP
 ON FILE IN THE OFFICE OF THE COUNTY
 RECORDER, COUNTY OF ALAMEDA. OF-
 FICE INFORMATION OR CALCULATIONS
 MAY HAVE BEEN ADDED HEREON

DETAIL LOTS 24 & 25 BIK. C
 Showing Storm Drain Easements
 SCALE: 1" = 50'

Existing 6'
 Storm Drain Easement
 Tract 2166, Book 42 of Maps, Pages 46 and 47

BASIS OF BEARINGS

TRACT 2084, EDEN TOWNSHIP,
 ALAMEDA COUNTY, CALIFORNIA

LEGEND

EXISTING MONUMENT
 CONCRETE MONUMENT WITH CAST IRON FRAME
 AND COVER - TO BE INSTALLED
 ANCHOR EASEMENT (SEE DETAIL BELOW) A.E.

BUILDING SET-BACK LINES

BUILDING SET-BACK LINES TO BE AS REQUIRED
 BY THE ORDINANCE CODE OF THE COUNTY OF
 ALAMEDA, TITLE 9, CHAPTER 2.

ANCHOR EASEMENT DETAIL

(NOT DRAWN TO SCALE)

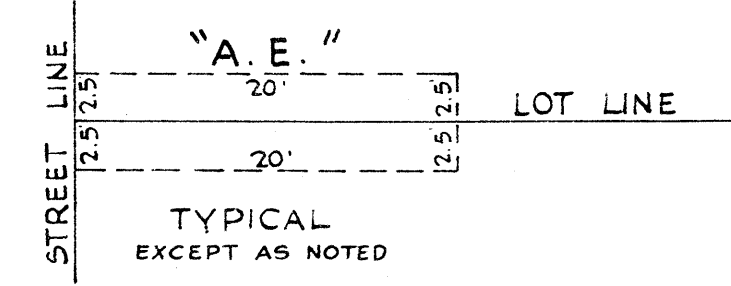

TRACT 2478

EDEN TOWNSHIP
ALAMEDA COUNTY, CALIFORNIA
 IN UNINCORPORATED TERRITORY IN THE COUNTY OF ALAMEDA

SCALE: 1" = 100' APRIL, 1965
 MURRAY & MCCORMICK, INC.
 CONSULTING CIVIL ENGINEERS
 SAN LEANDRO, CALIFORNIA

DETAIL LOTS 25, 26, 55 & 56 BIK. D
 Showing Sanitary Sewer & Storm Drain
 Easements
 SCALE: 1" = 60'

This is a copy of a map on file in the Recorder's Office
 of Alameda County. No representation of any kind is made
 as to the accuracy of the original official map from which
 this is copied, and this copy carries with it no representa-
 tion of any kind other than that it is a copy.

Any questions concerning this map should be directed
 to the Recorder's Office of Alameda County.
 DIETERICH POST COMPANY