

p:\2021\1022 - rb american group - heber springs, ar\drawings\lp-101.dwg

PLANT SCHEDULE

| Key | Botanical Name | Common Name | Quantity | Size | Condition | Remarks |
|------------------|-----------------------|----------------------|----------|-------|-----------|---------------|
| SHADE TREES | | | | | | |
| AR | ACER RUBRUM | RED MAPLE | 4 | 3 IN | B&B | MULTI-STEM |
| GI | GLEDITSIA TRIACANTHOS | HONEY LOCUST | 2 | 3 IN | B&B | MULTI-STEM |
| DECIDUOUS SHRUBS | | | | | | |
| CJ | CALICARPA JAPONICA | JAPANESE BEAUTYBERRY | 9 | 24 IN | #3 CONT. | 42" ON CENTER |
| VA | VACCINIUM ARBOREUM | FARKLEBERRY | 10 | 12 IN | #3 CONT. | 42" ON CENTER |

LEGEND OF EXISTING FEATURES

| | | | |
|-----|-----------------------|-------|-----------------------|
| --- | PROPERTY LINE | ⬮ | BENCHMARK |
| --- | RIGHT-OF-WAY LINE | ○ RBC | MONUMENT |
| --- | SETBACK LINE | △ | SECTION CORNER |
| --- | EASEMENT | ET HC | TRANSFORMER |
| --- | SECTION LINE | E M | ELECTRIC METER |
| --- | CENTERLINE | ⊘ | ELECTRIC MANHOLE |
| --- | 799 | ⊘ | POWER POLE GUY WIRE |
| --- | 800 | ☆ | LIGHT POLE |
| --- | INDEX CONTOUR | ⊘ | TELEPHONE PEDESTAL |
| --- | TELEPHONE UNDER GR. | ⊘ | TELEPHONE MANHOLE |
| --- | TELEPHONE OVERHEAD | TR | GAS MARKER |
| --- | FIBER OPTIC SERVICE | ⊘ | ELECTRIC MARKER |
| --- | GAS SERVICE | ⊘ | TRAFFIC POLE |
| --- | POWER UNDERGROUND | ⊘ | TRAFFIC MANHOLE |
| --- | POWER OVERHEAD | ⊘ | GAS METER |
| --- | WATER SERVICE | ⊘ | GAS VALVE |
| --- | SANITARY SEWER | ⊘ | STORM MANHOLE |
| --- | STORM SEWER | ⊘ | SANITARY MANHOLE |
| --- | POND NORMAL POOL | ⊘ | STORM INLETS |
| --- | EX. FLOWLINE | ⊘ | CLEAN-OUT |
| --- | CHAIN LINK FENCE | ⊘ | DOWNSPOUT |
| --- | FARM FENCE | ⊘ | FIRE HYDRANTS |
| --- | WOOD FENCE | ⊘ | WATER METER |
| --- | IRON FENCE RAILING | ⊘ | WATER VALVES |
| --- | BUILDING STRUCTURE | ⊘ | POST INDICATOR VALVE |
| --- | EX. BUILDING OVERHEAD | ⊘ | FIRE DEPARTMENT CONN. |
| --- | RIM | ⊘ | SIGNS |
| --- | INV. | ⊘ | MAILBOX |
| --- | FFE | ⊘ | ADA PARKING |
| --- | | ⊘ | PARKING COUNT |
| --- | | ⊘ | TREES |
| --- | | ⊘ | SHRUB |
| --- | | ⊘ | SPOT GRADE |

LANDSCAPE LEGEND - PROPOSED

| | | | |
|-----|---------------------|---|-----------------|
| --- | HARDWOOD MULCH | ⊘ | EVERGREEN TREE |
| --- | PERMANENT SEEDING | ⊘ | DECIDUOUS TREE |
| --- | SOD | ⊘ | DECIDUOUS TREE |
| --- | PERENNIAL PLANTINGS | ⊘ | ORNAMENTAL TREE |
| --- | LANDSCAPE EDGING | ⊘ | ORNAMENTAL TREE |
| --- | DECIDUOUS SHRUB | ⊘ | ORNAMENTAL TREE |
| --- | DECIDUOUS SHRUB | ⊘ | ORNAMENTAL TREE |
| --- | EVERGREEN SHRUB | ⊘ | MULTI-STEM TREE |
| --- | ORNAMENTAL GRASS | ⊘ | |
| --- | PLANT TAG | ⊘ | |

REVISION BLOCK



| | |
|------------|------------|
| DATE | 10/22/2021 |
| DRAWN BY | HYC |
| CHECKED BY | KPB |

HAMILTON DESIGNS

A LIMITED LIABILITY COMPANY

11 Municipal Drive, Suite 300
Fishers, Indiana 46038
P. (317) 570-9800
www.hamilton-designs.com

ARBY'S | HEBER SPRINGS

1632 Heber Springs Road
Heber Springs, Arkansas 72543

RB AMERICAN GROUP, LLC

6200 Oak Tree Blvd., Suite 250
Independence, Ohio 44131

| | |
|-------------|----------------|
| PROJECT NO. | 2021-0122 |
| DATE | 10/22/2021 |
| SCALE | 1" = 20' |
| SHEET NAME | LANDSCAPE PLAN |
| SHEET NO. | LP-101 |

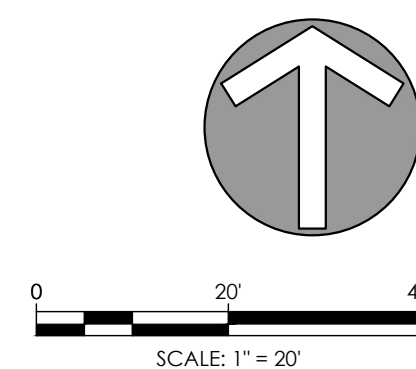

p:\2021\10\22 - rb american group - heber springs, mo\drawings\lp-501.dwg

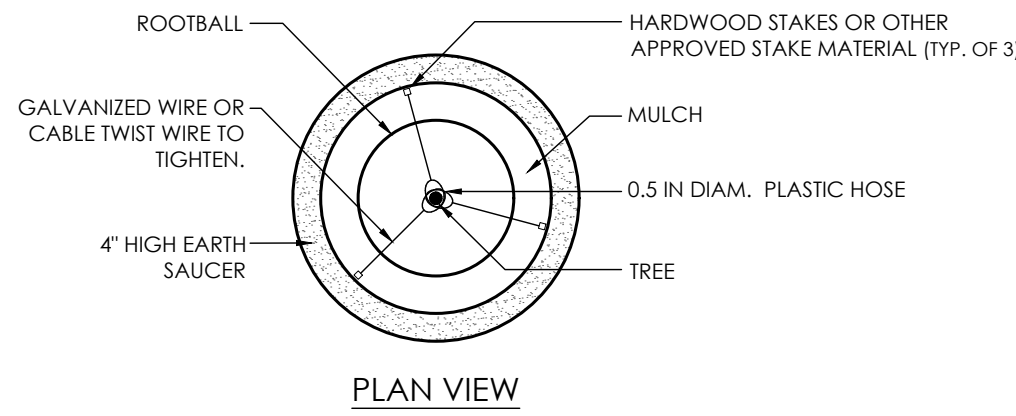

1. LOCATE (1) STAKE DIRECTLY SOUTHWEST OF TREE TRUNK

TREE STAKING DETAIL

NOT TO SCALE

WIRE OR CABLE SIZES SHALL BE AS FOLLOWS:
TREES UP TO 2.5 IN CALIPER - 14 GAUGE
TREES 2.5 IN TO 75 MM 3 IN CALIPER - 12 GAUGE

TIGHTEN WIRE OR CABLE ONLY ENOUGH TO KEEP FROM SLIPPING. ALLOW FOR SOME TRUNK MOVEMENT. PLASTIC HOSE SHALL BE LONG ENOUGH TO ACCOMMODATE 1.5 IN OF GROWTH AND BUFFER ALL BRANCHES FROM THE WIRE.

TUCK ANY LOOSE ENDS OF THE WIRE OR CABLE INTO THE WIRE WRAP SO THAT NO SHARP WIRE ENDS ARE EXPOSED.

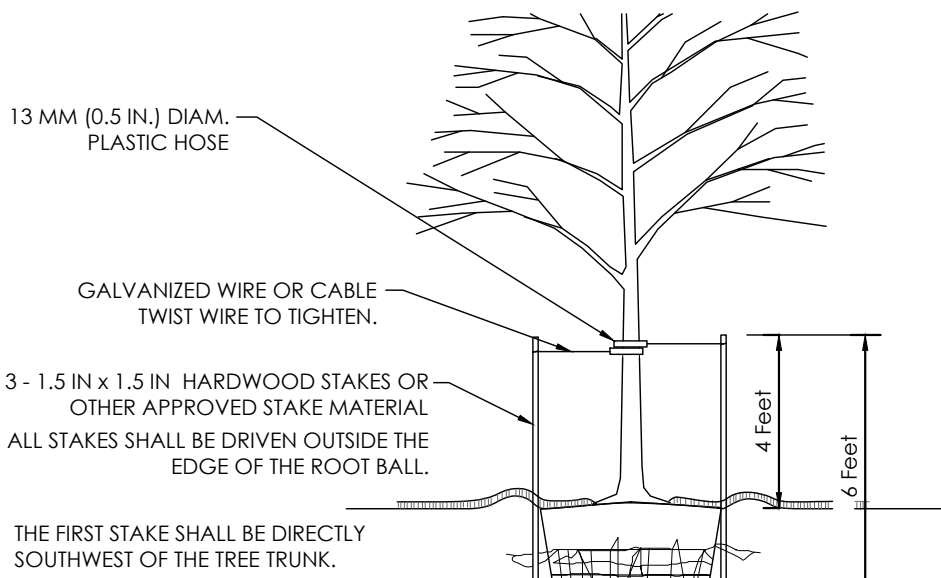

ASSURE THAT THE BEARING SURFACE OF THE PROTECTIVE COVERING OF THE WIRE OR CABLE AGAINST THE TREE TRUNK IS A MINIMUM OF 0.5 IN.

REMOVE ALL STAKING AS SOON AS THE TREE HAS GROWN SUFFICIENT ROOTS TO OVERCOME THE PROBLEM THAT REQUIRED THE TREE TO BE STAKED. STAKES SHALL BE REMOVED NO LATER THE END OF THE FIRST FULL GROWING SEASON AFTER PLANTING. IT SHALL BE THE CONTRACTOR'S RESPONSIBILITY TO REMOVE STAKING MATERIALS.

TREE STAKING DETAIL, 3" CALIPER OR LESS

NOT TO SCALE

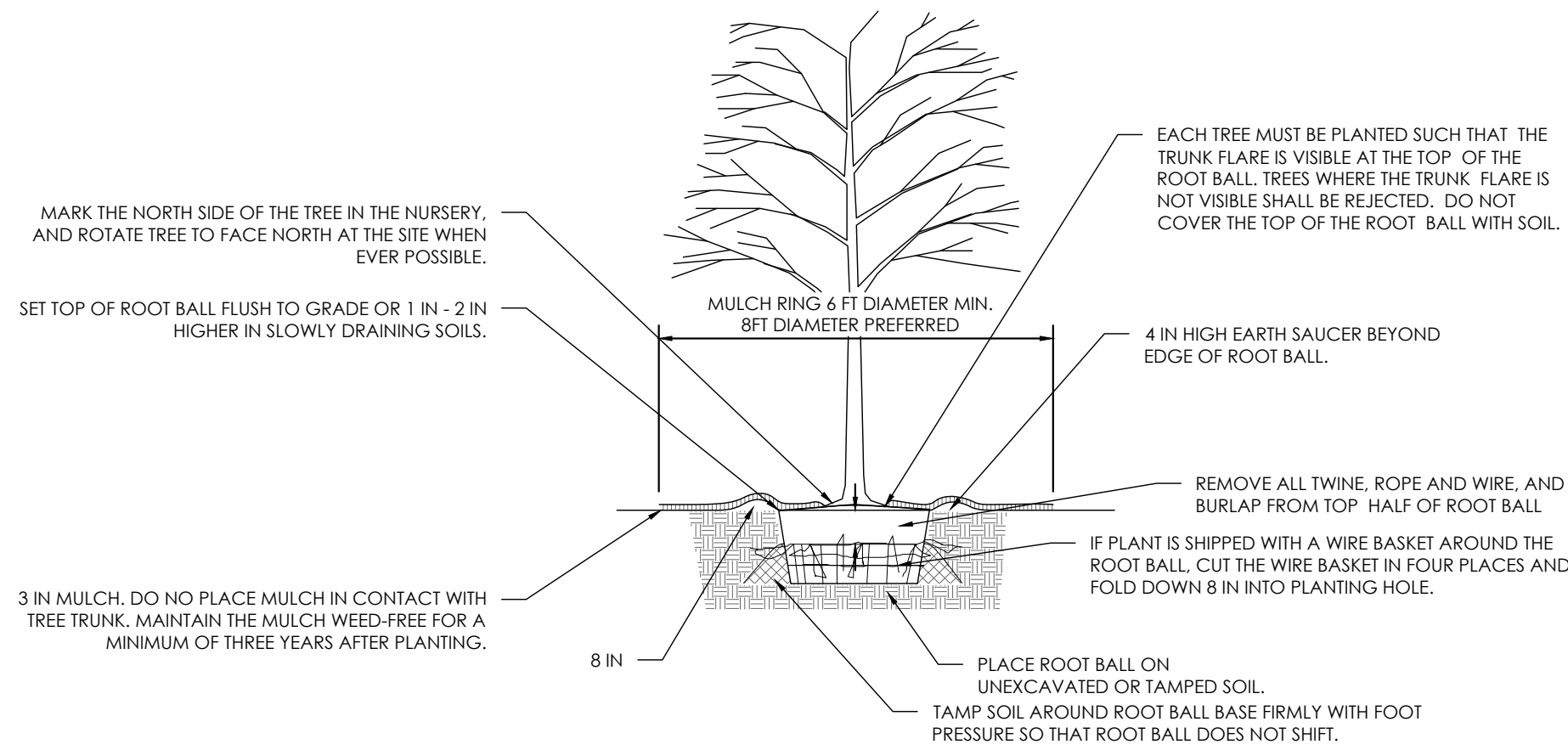

- NOTE:
1. THIS DETAIL ASSUMES THAT THE PLANTING SPACE IS LARGER THAN AN 8' SQUARE OPEN TO THE SKY, AND NOT COVERED BY ANY PAVING OR GRATING.
 2. STAKE TREES ONLY UPON THE APPROVAL OF THE LANDSCAPE ARCHITECT
 3. WRAP TREE TRUNKS ONLY UPON THE APPROVAL OF THE LANDSCAPE ARCHITECT.
 4. DO NOT HEAVILY PRUNE THE TREE AT PLANTING. PRUNE ONLY CROSSOVER LIMBS, CO-DOMINANT LEADERS, AND BROKEN OR DEAD BRANCHES. SOME INTERIOR TWIGS AND LATERAL BRANCHES MAY BE PRUNED; HOWEVER, DO NOT REMOVE THE TERMINAL BUDS OF BRANCHES THAT EXTEND TO THE EDGE OF THE CROWN.
 5. FOR DIMENSIONS OF PLANTING AREAS, TYPES OF SOIL, AMENDMENTS, OR SOIL REPLACEMENT, SEE "SOIL IMPROVEMENT DETAILS"

TREE PLANTING DETAIL, FOR B&B ALL SOIL TYPES

NOT TO SCALE

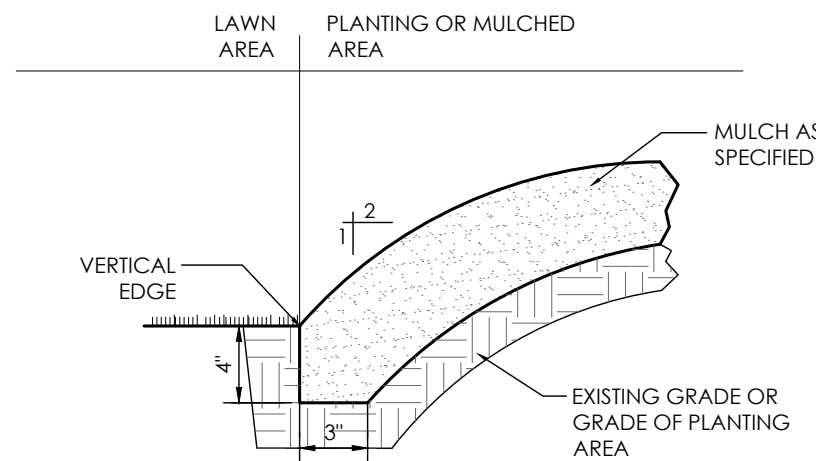

NOTE:
TRENCH EDGE SHALL CREATE A CLEAN SEPARATION BETWEEN AREAS; AND SHALL CREATE SMOOTH AND EVEN LINES (AS INDICATED ON THE PLANS).

SPADE EDGE

NOT TO SCALE

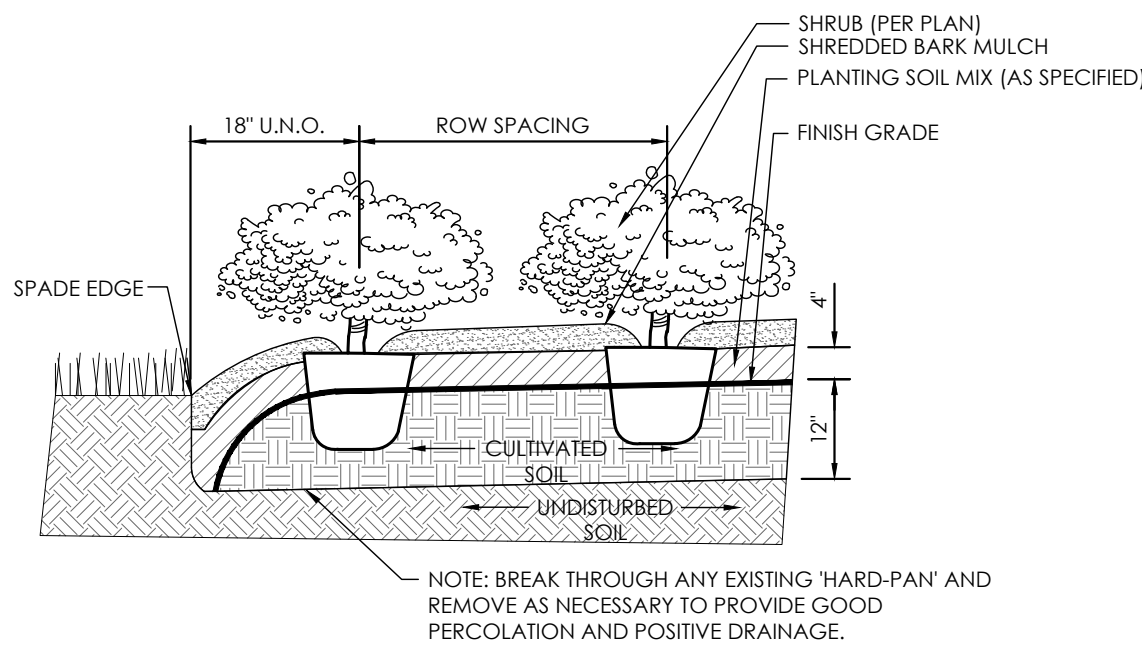

PLANTING PROCEDURE

1. LAYOUT BED AND OUTLINE WITH SPADE EDGE.
2. ROTOTILL BED TO 12" DEPTH.
3. SPREAD 4" MIN. LAYER OF PLANTING SOIL MIX OVER BED.
4. ROTOTILL PLANTING SOIL MIX INTO TOP OF BED.
5. INSTALL PLANTS, MULCH, AND WATER THOROUGHLY.

SHRUB MASS PLANTING

NOT TO SCALE

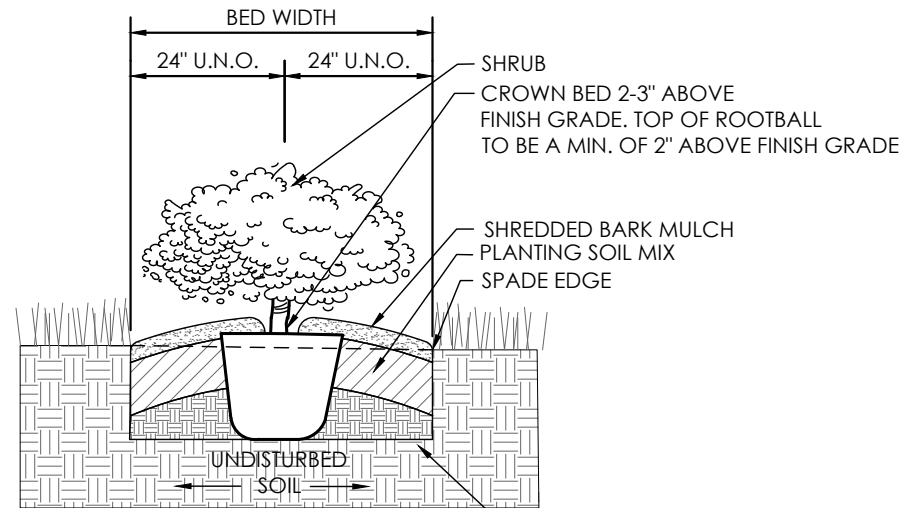

PLANTING PROCEDURE

1. LAYOUT BED AND OUTLINE WITH SPADE EDGE.
2. ROTOTILL BED TO 12" DEPTH.
3. SPREAD 4" MIN. LAYER OF PLANTING SOIL MIX OVER BED.
4. ROTOTILL PLANTING SOIL MIX INTO TOP OF BED.
5. INSTALL PLANTS, MULCH, AND WATER THOROUGHLY.

HEDGE PLANTING

NOT TO SCALE

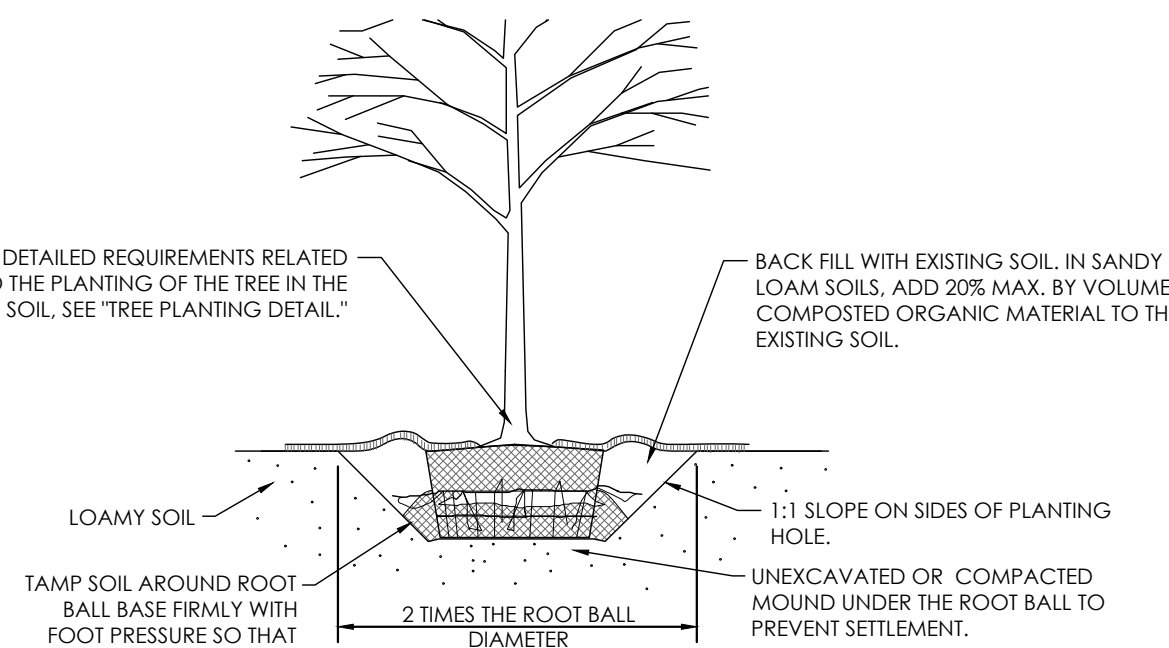

NOTE: FOR DETAILED REQUIREMENTS RELATED TO THE PLANTING OF THE TREE IN THE IMPROVED SOIL, SEE "TREE PLANTING DETAIL."

LOAMY SOILS INCLUDE THE FOLLOWING USDA TEXTURAL CLASSIFICATIONS AND HAVE A CLAY CONTENT OF BETWEEN 15 TO 27%: LOAM, SANDY LOAM AND SILT LOAM. NOTE THAT SOILS AT THE OUTER LIMITS OF THE LOAM CLASSIFICATIONS MAY PRESENT SPECIAL PLANTING PROBLEMS NOT ANTICIPATED BY THIS DETAIL.

LOAMY SOILS ARE DEFINED AS GRANULAR OR BLOCKY FRIABLE SOILS, A MIXTURE OF SAND, SILT AND CLAY PARTICLES WITH A MINIMUM OF 1.5% BY DRY WEIGHT ORGANIC MATTER. THE SOIL MUST NOT BE SO COMPACTED AS TO IMPEDE ROOT GROWTH OR DRAINAGE. THE SOIL STRUCTURE SHALL NOT BE PLATY OR MASSIVE. THE SOIL MUST BE TESTED FOR TEXTURE, DRAINAGE CAPABILITY, PH, AND NUTRIENT VALUES PRIOR TO DETERMINING ANY ADDITIONAL SOIL IMPROVEMENTS. CONTRACTOR SHALL CONSULT LANDSCAPE ARCHITECT IN POOR SOIL CONDITIONS.

1. TREES PLANTED IN NON RESTRICTED SOIL CONDITIONS. THIS DETAIL ASSUMES THAT THE AREA OF LOAMY SOIL AVAILABLE TO EACH TREE IS A MINIMUM OF 500 SQUARE FEET.

SOIL IMPROVEMENT DETAIL

NOT TO SCALE

REVISION BLOCK



DATE
10/22/2021

DRAWN BY
HYC

CHECKED BY
TLP

HAMILTON DESIGNS

A LIMITED LIABILITY COMPANY

11 Municipal Drive, Suite 300
Fishers, Indiana 46038
P. (317) 570-9800
www.hamilton-designs.com

CONSTRUCTION PLANS FOR:

ARBY'S | HEBER SPRINGS

1632 Heber Springs Road
Heber Springs, Arkansas 72543

RB AMERICAN GROUP, LLC

6200 Oak Tree Blvd., Suite 250
Independence, Ohio 44131

PROJECT NO.
2021-0122

DATE
10/22/2021

SCALE

SHEET NAME

**LANDSCAPE
DETAILS**

SHEET NO.

LP-501