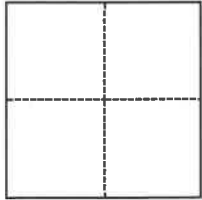

# CORNER RECORD

Agency Index BK 151 PG 39Document Number CR 16376City of Oakland County of Alameda, CaliforniaBrief Legal Description Monument at intersection of Coolidge Ave. & Davis St. near 2678 Coolidge Ave.**CORNER TYPE****COORDINATES (Optional)**

- ☐ Government Corner ☒ Control  
☐ Meander ☐ Property  
☐ Rancho ☐ Other

Date of Survey November 15, 2022

N. \_\_\_\_\_ E. \_\_\_\_\_

Elevation \_\_\_\_\_

Units ☐ Metric ☒ U.S. Survey Foot

Horizontal Datum \_\_\_\_\_

Zone \_\_\_\_\_ Epoch Date \_\_\_\_\_

Vertical Datum \_\_\_\_\_

☐ Complies with Public Resources Code §§8801-8819☐ Complies with Public Resources Code §§8890-8902PLS Act Ref.: ☐ 8765(d) ☒ 8771 ☐ 8773 ☐ Other:Corner/ ☒ Left as found ☐ Established ☐ Rebuilt ☒ Pre-ConstructionMonument: ☐ Found and tagged ☐ Reestablished ☒ Referenced ☐ Post-Construction

Narrative of corner identified and monument as found, set, reset, replaced, or removed:

☐ See sheet #2 for description(s):

Found monument that could be damaged or destroyed by planned water line construction project. Monument was referenced per CR 10868(104 CR51); as shown on page 2. The purpose of this Corner Record is to preserve possible evidence only; no attempt was made to determine the relationship to property, centerline, or right of way lines.

Reference EBMUD Field Book C, Page 184 (Doring /Johnson)

**SURVEYOR'S STATEMENT**

This Corner Record was prepared by me or under my direction in conformance with

the Professional Land Surveyors' Act on January 30, 2023Signed [Signature] P.L.S. or R.C.E. No. 8889**COUNTY SURVEYOR'S STATEMENT**

This Corner Record was received \_\_\_\_\_

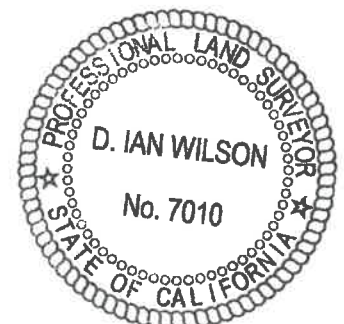
and examined and filed FEB 02 2023Signed FEB 02 2023 D. Ian Wilson P.L.S. or R.C.E. No. 7010Title County Surveyor**County Surveyor's Comment**

**OAKLAND****ALAMEDA COUNTY**

DEERING TRACT

16 M 31

68

DAVIS STREET  
(60' WIDE)COOLIDGE AVENUE  
(60' WIDE)

62

61

15 M 62

2678 COOLIDGE AVENUE  
APN 27-873-10[100.97']  
SD INLET  
AT RETURN[100.43']  
1.5' SW TO  
CONC SD INLET[100.00']  
BA5IF3[100.28']  
4.1' NW TO  
SIGN POSTDAVIS STREET  
(55' WIDE)SCALE  
1"=20'**LEGEND**

- ⊙ FOUND 1/4" PIN IN CONCRETE POST, IN STANDARD MONUMENT WELL, DOWN 1.3', IN GOOD CONDITION
- FOUND ANCHOR NAIL WITH 1-1/2" ALUMINUM WASHER, STAMPED "EBMUD MON RP", IN TOP OF CONCRETE CURB PER CR 10868 (104 CR 51)
- SET ANCHOR NAIL WITH 1-1/2" ALUMINUM WASHER, STAMPED "EBMUD MON RP", IN TOP OF CONCRETE CURB
- [ ] ASSUMED ELEVATION (MEASURED USING A LEICA DNA10 DIGITAL LEVEL)
- ( ) DISTANCE PER CR 10868 (104 CR 51)

AA##A# ALAMEDA COUNTY MONUMENT ID

ADDRESS: 2678 COOLIDGE AVENUE

APN: 27-873-10

