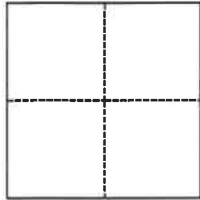

CORNER RECORD

Agency Index BK 140 PG 96Document Number CR 15527City of Oakland (APN 32-2030-166) County of Alameda, CaliforniaBrief Legal Description Monument at Suter Street and Viola Street, near 3728 Suter Street.**CORNER TYPE**

☐ Government Corner ☒ Control
☐ Meander ☐ Property
☐ Rancho ☐ Other

Date of Survey June 7, 2021**COORDINATES (Optional)**N. E. Elevation Units ☐ Metric ☒ U.S. Survey FootHorizontal Datum Zone Epoch Date Vertical Datum ☐ Complies with Public Resources Code §§8801-8819☐ Complies with Public Resources Code §§8890-8902

PLS Act Ref.:

☐ 8765(d)☒ 8771☐ 8773☐ Other:Corner/
Monument:☒ Left as found☐ Established☐ Rebuilt☒ Pre-Construction☐ Found and tagged☐ Reestablished☒ Referenced☐ Post-Construction

Narrative of corner identified and monument as found, set, reset, replaced, or removed:

☒ See sheet #2 for description(s):

Found monument that could be damaged or destroyed by planned water line construction project. Monument was referenced per CR 15192; as shown on page 2. The purpose of this Corner Record is to preserve possible evidence only; no attempt was made to determine the relationship to property, centerline, or right of way lines.

Reference EBMUD CR Book B, Page 121 (Taaning/Chou)

SURVEYOR'S STATEMENT

This Corner Record was prepared by me or under my direction in conformance with

the Professional Land Surveyors' Act on September 9, 2021Signed  P.L.S. or R.C.E. No. 8889**COUNTY SURVEYOR'S STATEMENT**

This Corner Record was received

and examined and filed

SEP 14 2021Signed  P.L.S. or R.C.E. No. 7010Title ALAMEDA COUNTY SURVEYOR

County Surveyor's Comment

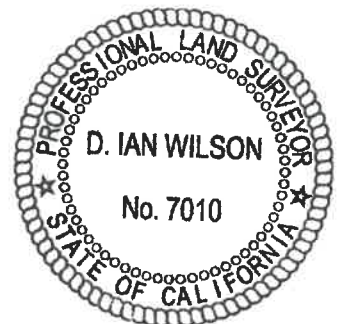

OAKLAND

ALAMEDA COUNTY

VALLEY VIEW TRACT

23 M 44

BLOCK E

3728 SUTER STREET
APN 32-2030-166

SUTER STREET

VIOLA STREET

0.6' OFF BACK OF
N'LY SIDEWALK
17.9' N'LY OF
STORM DRAIN[100.41']
5' OFF EDGE DWY34.61'
(34.60')

28.18'

[100.00']

31.26'

1' OF BACK OF
SIDEWALK AT CURVE
9' N'LY OF SW
CURB RETURN23 M 44
BLOCK C
8[100.90']
0.3' OFF EDGE DWY21.99'
(21.99')FAIRVIEW
HEIGHTS
24 M 7
BLOCK F**LEGEND**

FOUND 1/4" PIN IN CONCRETE, DOWN 1.2' IN STANDARD MONUMENT WELL

FOUND CONCRETE ANCHOR NAIL WITH 1-1/2" ALUMINUM WASHER STAMPED
"EBMUD MON RP" IN TOP OF CURB PER CR 15192SET CONCRETE ANCHOR NAIL WITH 1-1/2" ALUMINUM WASHER STAMPED
"EBMUD MON RP" IN TOP OF CURB

[] ELEVATION (MEASURED USING A LEICA DIGITAL LEVEL) PER CR 15192

() RP DISTANCE PER CR 15192

ADDRESS: 3728 SUTER STREET

APN: 32-2030-166

SCALE
1"=20'