

SECTION 1
Scale= 3/4" = 1'-0" A-302

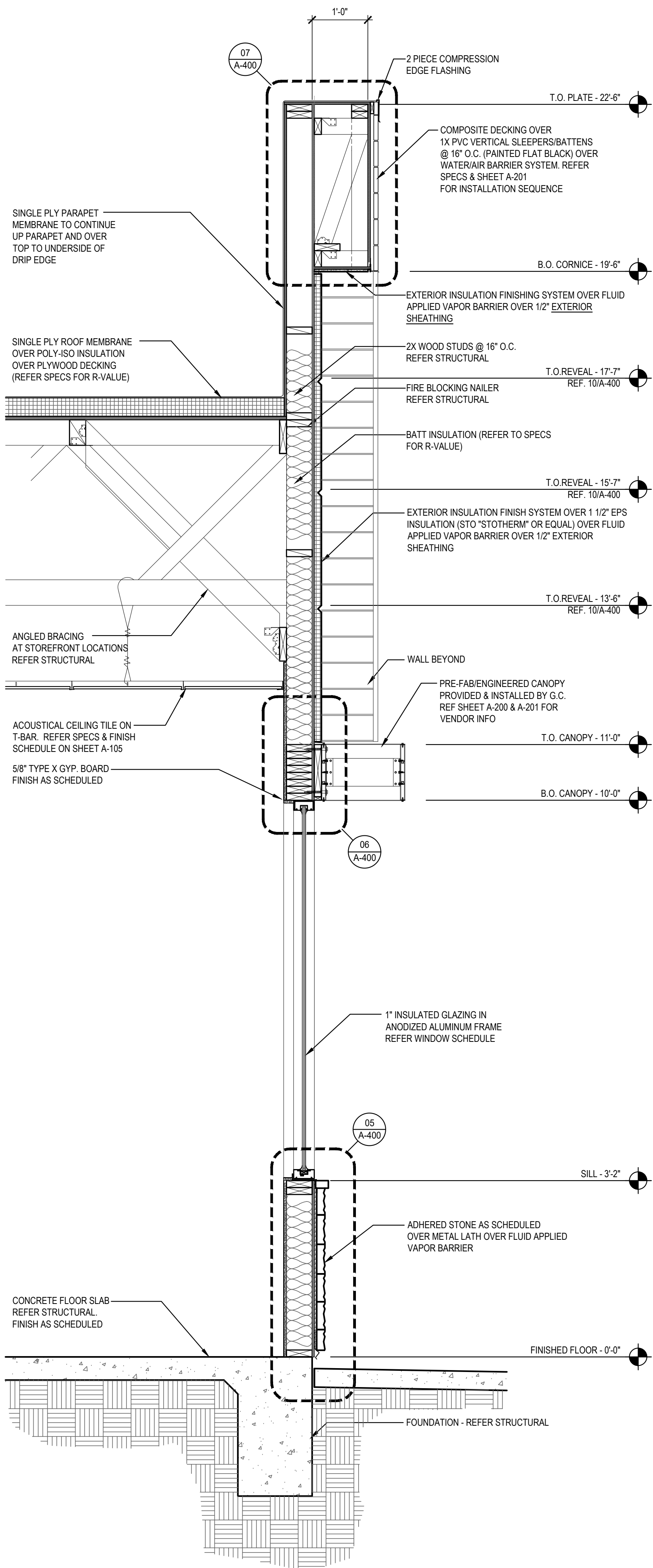

SECTION 2
Scale= 3/4" = 1'-0" A-302

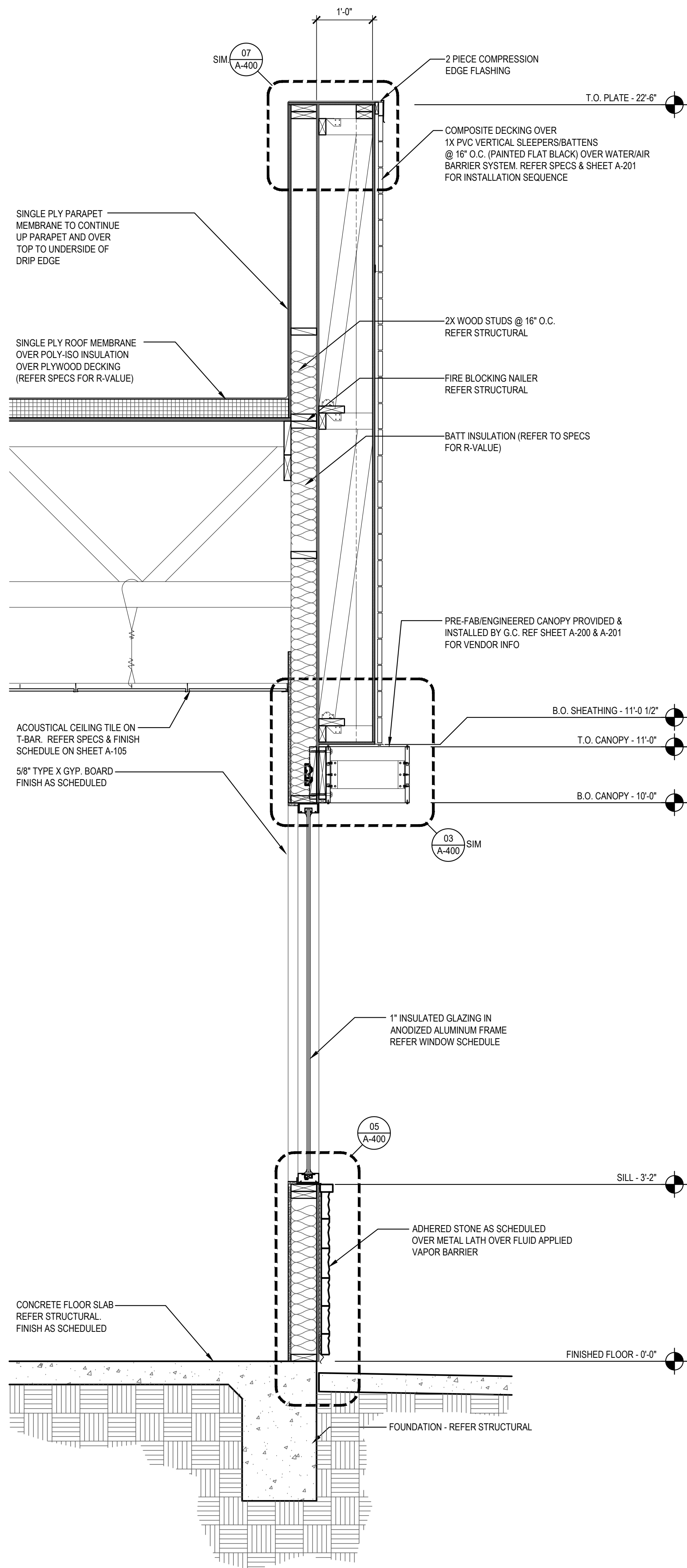

SECTION 3
Scale= 3/4" = 1'-0" A-302



PANDA RESTAURANT GROUP INC.
1683 Walnut Grove Ave.
Rosemead, California
91770
Telephone: 626.799.9898
Facsimile: 626.372.8288

All ideas, designs, arrangement and plans indicated or represented by this drawing are the property of Panda Express Inc. and were created for use on this specific project. None of these ideas, designs, arrangements or plans may be used by or disclosed to any person, firm, or corporation without the written permission of Panda Express Inc.

REVISIONS:

1	04.29.2021	ISSUE FOR PERMIT
2	06.04.2021	ISSUE FOR BID

ISSUE DATE:

1	04.29.2021	ISSUE FOR PERMIT
2	06.04.2021	ISSUE FOR BID

DRAWN BY: JDV

PANDA PROJECT #: S8-22-D8135
C&P PROJECT #: 2200775



06.04.2021

PANDA EXPRESS
TRUE WARM AND WELCOME 2300
SKYBROOKE BOULEVARD & STATE ROAD 54
LUTZ, FL 33558

A-302

WALL SECTIONS

TRUE WARM & WELCOME 2300 R4