

CORNER RECORD

Agency Index BK 149 PG 65
Document Number CR 16248

City of UNINCORPORATED (SAN LORENZO) County of ALAMEDA, California
Brief Legal Description INTERSECTION HESPERIAN BOULEVARD & HACIENDA AVE

CORNER TYPE

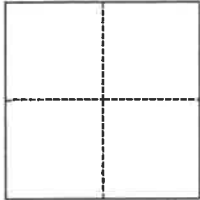

- ☐ Government Corner ☐ Control
☐ Meander ☐ Property
☐ Rancho ☒ Other

Date of Survey May 23, 2022

COORDINATES (Optional)

N. _____ E. _____
Elevation _____
Units ☐ Metric ☐ U.S. Survey Foot
Horizontal Datum _____
Zone _____ Epoch Date _____
Vertical Datum _____
☐ Complies with Public Resources Code §§8801-8819
☐ Complies with Public Resources Code §§8890-8902

PLS Act Ref.: ☐ 8765(d) ☒ 8771 ☐ 8773 ☐ Other:
Corner/
Monument: ☒ Left as found ☐ Established ☐ Rebuilt ☒ Pre-Construction
☐ Found and tagged ☐ Reestablished ☒ Referenced ☐ Post-Construction

Narrative of corner identified and monument as found, set, reset, replaced, or removed:

☐ See sheet #2 for description(s):

FOUND MONUMENT PER RS 2827 (43 RS 2) AS SHOWN ON SIDE 2. SET BRASS NAILS & TAGS STAMPED "ALA CO SURV" IN LEAD IN TOP OF CURB, UNLESS OTHERWISE NOTED, AS STRADDLERS FOR FOUND MONUMENT. NO PREVIOUS 8771(b) CORNER RECORD ON FILE.

SURVEYOR'S STATEMENT

This Corner Record was prepared by me or under my direction in conformance with

the Professional Land Surveyors' Act on August 12, 2022

Signed (P.L.S.) or R.C.E. No. 8427



COUNTY SURVEYOR'S STATEMENT

This Corner Record was received _____

and examined and filed SEP 28 2022

Signed (P.L.S.) or R.C.E. No. 7010

Title ALAMEDA COUNTY SURVEYOR

County Surveyor's Comment _____



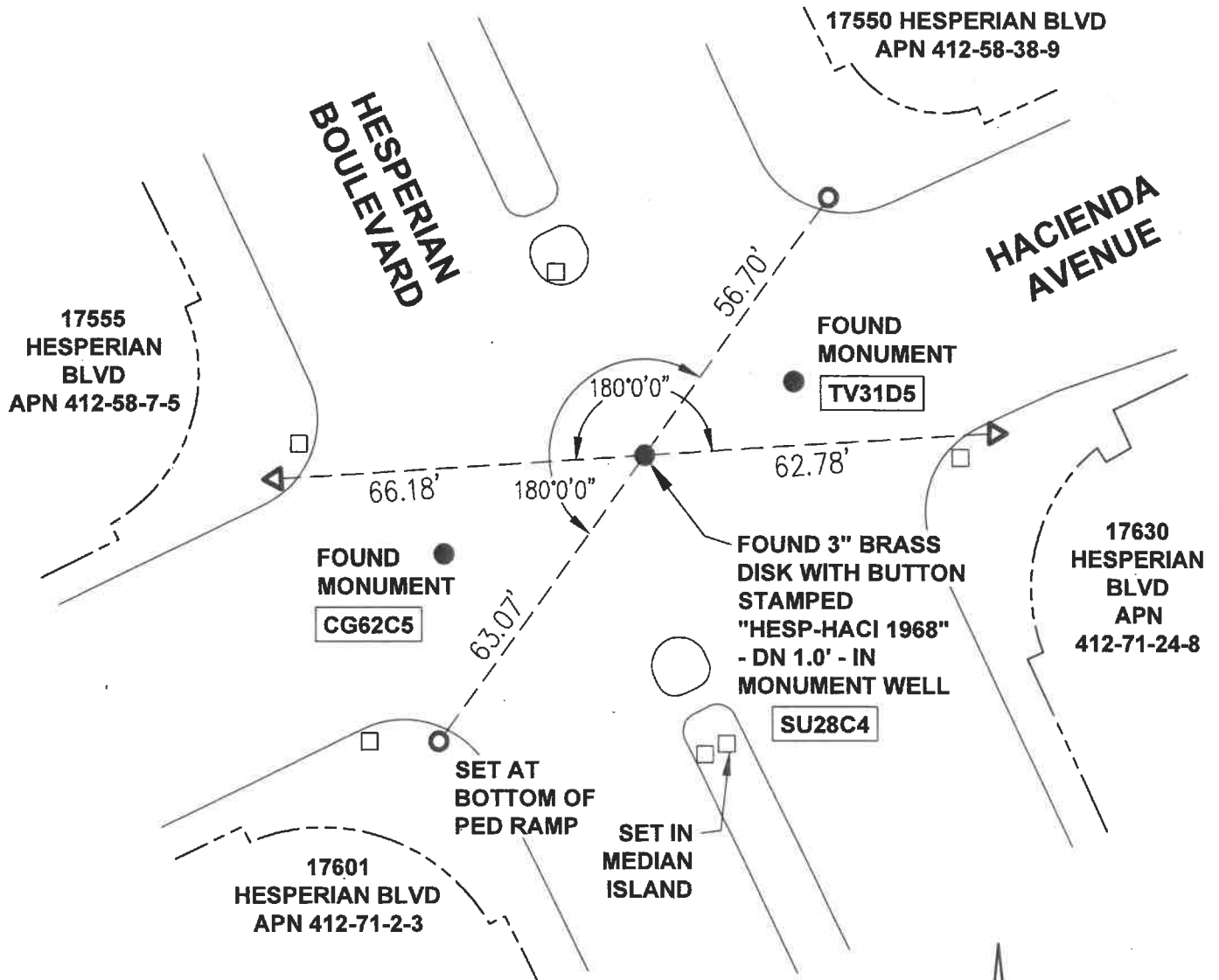

LEGEND

AA##A#	ALAMEDA COUNTY MONUMENT ID
○	SET BRASS NAIL AND TAG "ALA CO SURV" IN LEAD IN TOP OF CURB
□	SET BRASS NAIL AND TAG "ALA CO SURV" IN LEAD IN TOP OF CURB REFERENCING OTHER MONUMENTS
△	SET MAG NAIL AND TAG "ALAMEDA COUNTY SURVEYOR" IN TOP OF CURB
#####	STREET ADDRESS
—————	CURB LINE
- - - - -	PROPERTY LINE
APN	ASSESSOR'S PARCEL NUMBER

