

Scale: 1" = 300'

Toma & Anderson
Licensed Land Surveyors
41 Summit Street
Jackson, California
(209) 223-0156

PARCEL MAP No. 2388
OF
MURIETA RANCHES
UNIT 1
BEING A PORTION OF SECTION'S 28, 29, 32 & 33, T.7N, R. 10E, M.D.M.
COUNTY OF AMADOR, STATE OF CALIFORNIA

October, 1992

OWNER'S STATEMENT

THE UNDERSIGNED HEREBY CERTIFIES THAT THEY ARE THE OWNERS OF REAL PROPERTY SHOWN HEREIN AS THE SUBDIVISION AND THAT THEY DO HEREBY CONSENT TO THE PREPARATION AND RECORDATION OF THIS MAP, AND, IN CONSIDERATION FOR AND AS A CONDITION OF APPROVAL OF SAID MAP THEY DO HEREBY:

MAKE AN IRREVOCABLE OFFER TO DEDICATE TO THE PUBLIC FOR ITS USE AND CONVENIENCE AS A PUBLIC UTILITY EASEMENT IN, ON, OVER, ABOVE, OR UNDER EACH AND EVERY PART OF SAID SUBDIVISION DESIGNATED ON THIS MAP AS A "UTILITY EASEMENT" AND ON, OVER, ACROSS, AND THROUGH THOSE STRIPS OF LAND LYING 5 FEET ON EACH SIDE OF ALL SIDE LOT LINES AND REAR LOT LINES AND 10 FEET ALONG THE EXTERIOR BOUNDARIES OF THIS SUBDIVISION AND FRONT LOT LINES, AN EASEMENT FOR SAID COUNTY OR ITS DESIGNEES AT ANY TIME, OR FROM TIME TO TIME, TO ENTER, CONSTRUCT, MAINTAIN, OPERATE, REPLACE, REMOVE, RENEW, ENLARGE, AND PROTECT FROM HAZARDS, SANITARY SEWERS, STORM DRAINS, LINES OR PIPE, CONDUITS, CABLES, WIRES, POLES AND NECESSARY FIXTURES AND EQUIPMENT THEREFOR, TO CONNECT ANY PUBLIC UTILITY SERVICE TO ANY PARCEL OR LOT INSIDE OR OUTSIDE OF SAID SUBDIVISION AND/OR TO ANY MAIN OR TRUNK LINE OR SYSTEM; AND

1.) MAKE AN IRREVOCABLE OFFER TO DEDICATE TO THE PUBLIC FOR ITS USE AND CONVENIENCE:

2.) EASEMENTS FOR DRAINAGE PURPOSES ON, OVER, ACROSS, UNDER AND THROUGH ALL NATURAL DRAINAGE COURSES AND THOSE PORTIONS OF LAND SHOWN HEREON DESIGNATED AS DRAINAGE EASEMENT; AND

SAID OFFERS TO DEDICATE AND AGREEMENTS AND COVENANTS ARE IRREVOCABLE AND SHALL RUN WITH THE LAND AND BE BINDING UPON ANY FUTURE OWNERS, ENCUMBRANCERS, SUCCESSORS, HEIRS OR ASSIGNS, AND SHALL CONTINUE IN EFFECT UNTIL EXPRESSLY AND LAWFULLY ABANDONED AND TERMINATED BY THE BOARD OF SUPERVISORS OF SAID COUNTY. SAID BOARD IN REJECTING ANY AND ALL OF SAID OFFERS TO DEDICATE SHALL RETAIN THE RIGHT TO ACCEPT BY RESOLUTION ANY OR ALL SAID OFFERS AT ANY TIME THEREAFTER.

OWNERS PER

518-O.R.-458, 555-O.R.-303 & 573-O.R.-423

George L. Cook TITLE *President*
COOK INVESTMENT CORPORATION,
A CALIFORNIA CORPORATION

James Craig
JAMES CRAIG

Susan C. Craig
SUSAN C. CRAIG

Kathleen R. Mastagni
KATHLEEN R. MASTAGNI

CLERK OF THE BOARD OF SUPERVISORS

I, CATHERINE GIANINNI, HEREBY CERTIFY THAT I AM THE CLERK OF THE BOARD OF SUPERVISORS OF AMADOR COUNTY, CALIFORNIA: THAT THE BOARD BEING THE PROPER APPROVING BODY ACCEPTS THE DEDICATIONS OF ALL PUBLIC UTILITY EASEMENTS,

BUT REJECTS AT THIS TIME, ALL OTHER OFFERS OF DEDICATION APPEARING ON THIS MAP, SAID OFFERS MAY BE ACCEPTED BY RESOLUTION OF SAID BOARD AT ANY TIME HEREAFTER.

DATE: 11-19-93 . . .

Catherine J. Gianinni
CLERK TO THE BOARD OF SUPERVISORS

NOTARY'S CERTIFICATE

STATE OF CALIFORNIA
COUNTY OF *Sacramento*

ON *10/25/92*, BEFORE ME, A NOTARY IN AND FOR SAID STATE, PERSONALLY APPEARED *James Craig & Susan C. Craig* PERSONALLY KNOWN TO ME, (OR PROVED TO ME ON BASIS OF SATISFACTORY EVIDENCE) TO BE THE PERSON(S) WHOSE NAME(S) IS/ARE SUBSCRIBED TO THE WITHING INSTRUMENT AND ACKNOWLEDGED TO ME THAT HE OR SHE EXECUTED THE SAME IN THE CAPACITY(IES) INDICATED AT THE SIGNATURE POINT.

WITNESS MY HAND AND OFFICIAL SEAL
SIGNATURE *Cathy Ann Buck* NAME: *Cathy Ann Buck*
COUNTY: *Sacramento* LIC. EXP.: *10/19/93*

NOTARY'S CERTIFICATE

STATE OF CALIFORNIA
COUNTY OF *Sacramento*

ON *11-4-92*, BEFORE ME, A NOTARY IN AND FOR SAID STATE, PERSONALLY APPEARED *Kathleen R. Mastagni* PERSONALLY KNOWN TO ME, (OR PROVED TO ME ON BASIS OF SATISFACTORY EVIDENCE) TO BE THE PERSON(S) WHOSE NAME(S) IS/ARE SUBSCRIBED TO THE WITHING INSTRUMENT AND ACKNOWLEDGED TO ME THAT HE OR SHE EXECUTED THE SAME IN THE CAPACITY(IES) INDICATED AT THE SIGNATURE POINT.

WITNESS MY HAND AND OFFICIAL SEAL
SIGNATURE *Lavon M. Vincent* NAME: *Lavon M. Vincent*
COUNTY: *sacramento* LIC. EXP.: *Jan. 5, 1993*

NOTARY'S CERTIFICATE

STATE OF CALIFORNIA
COUNTY OF *SACRAMENTO*

ON *11-6-92*, BEFORE ME, A NOTARY IN AND FOR SAID STATE, PERSONALLY APPEARED *GEORGE L. COOK* PERSONALLY KNOWN TO ME, (OR PROVED TO ME ON BASIS OF SATISFACTORY EVIDENCE) TO BE THE PERSON(S) WHOSE NAME(S) IS/ARE SUBSCRIBED TO THE WITHING INSTRUMENT AND ACKNOWLEDGED TO ME THAT HE OR SHE EXECUTED THE SAME IN THE CAPACITY(IES) INDICATED AT THE SIGNATURE POINT.

WITNESS MY HAND AND OFFICIAL SEAL
SIGNATURE *Lorna E. Johnson* NAME: *LORNA E. JOHNSON*
COUNTY: *SACRAMENTO* LIC. EXP.: *2-13-96*

SURVEYOR'S STATEMENT

THIS MAP WAS PREPARED BY ME OR UNDER MY DIRECTION AND IS BASED UPON A FIELD SURVEY IN CONFORMANCE WITH THE REQUIREMENTS OF THE SUBDIVISION MAP ACT AND LOCAL ORDINANCE AT THE REQUEST OF COOK INVESTMENT CORPORATION, et. al.

ON OCTOBER 30, 1992, I HEREBY STATE THAT THIS PARCEL MAP SUBSTANTIALLY CONFORMS TO THE APPROVED TENTATIVE MAP.

C. L. Toma L.S. 3570
CIRO L. TOMA L.S. 3570
MY LICENSE EXPIRES 6/30/96

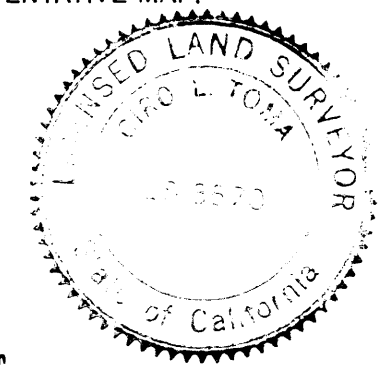

COUNTY SURVEYOR'S STATEMENT

THIS MAP CONFORMS WITH THE REQUIREMENTS OF THE SUBDIVISION MAP ACT AND LOCAL ORDINANCE.

DATE: *Oct. 22, 1993*

C. Lee DeLange
C. LEE DeLANGE L.S. 4066
AMADOR COUNTY DEPUTY SURVEYOR
MY LICENSE EXPIRES 6/30/96

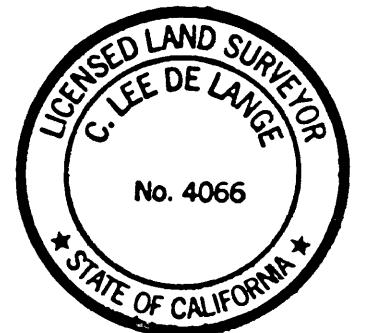

PLANNING DIRECTOR'S STATEMENT

I HEREBY CERTIFY THAT I HAVE EXAMINED PARCEL MAP No. AND THAT IT IS SUBSTANTIALLY THE SAME AS IT APPEARED ON THE TENTATIVE MAP AND ANY APPROVED ALTERATIONS THERETO. THAT ALL PROVISIONS OF AMADOR COUNTY CODE TITLE 17 HAVE COMPLIED WITH.

DATE: *Nov. 12, 1993*

SIGNED: *Susan C. Arjawa*
PLANNING DIRECTOR

RECORDER'S STATEMENT

FILED THIS *19th* DAY OF *Nov.*, 1993 AT *4:00pm* IN BOOK *47*

. OF MAPS AND PLATS, AT PAGE *96* . . . AT THE REQUEST

OF THE AMADOR COUNTY CLERK. TITLE TO LAND INCLUDED IN

THIS PARCEL MAP BEING VESTED AS PER CERTIFICATE No. *762*

ON FILE IN THIS OFFICE. *Instr. # 1993012280*

FEE: \$ *10.00*

Sheldon D. Johnson
SHELDON D. JOHNSON
AMADOR COUNTY RECORDER

BY: *Samis L. Swashio*
DEPUTY