

PARCEL MAP N° 36-86

IN THE COUNTY OF MONO, STATE OF CALIFORNIA,
BEING A DIVISION OF LOT 18 OF SIERRA
VALLEY SITES TRACT N° 1 AS SHOWN ON
THE MAP THEREOF RECORDED IN BOOK 1, PAGES
26 THRU 26B INCLUSIVE OF MAPS, RECORDS
OF SAID COUNTY, BEING A PORTION OF
THE NORTHEAST QUARTER OF SECTION 34,
TOWNSHIP 3 SOUTH, RANGE 27 EAST,
M.D.M. 4

Filed this 28th day of
August, 1980, at
10:35 A.M. in Book
of Maps, Vol. 1, at
Pages 28 and 28-A at
the request of David Tope.

Fee 1.00 Inst. N° 144

Rena Villa
Mono County Recorder
by:

Deputy Recorder

This map was prepared by me or under my direction
and is based upon a field survey in conformance with
the requirements of the Subdivision Map Act and local
ordinance at the request of David Tope on March 10, 1980.
I hereby state that this Parcel Map substantially con-
forms to the approved tentative map, if any.

Gordon C. Holmes
Gordon C. Holmes, RCE 10467

This map conforms with the requirements of the
Subdivision Map Act and local ordinance.

Dated: May 15, 1981.

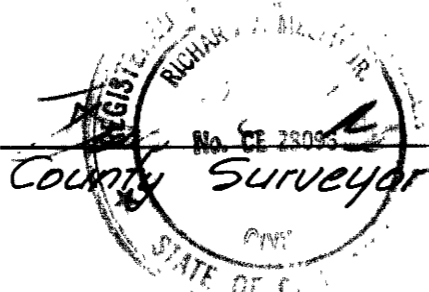

This land division map is in accordance with the con-
ditionally approved tentative map.

Dated: _____ Planning Commission

Chairman

I, the undersigned County Tax Collector of the County
of Mono, State of California, do hereby certify that
according to the records of this office there are no liens
of any kind against the lands shown on this map, or any
part thereof, for any delinquent county, municipal or
local taxes or special assessments.

Dated: May 1981.

County Tax Collector

We hereby certify that we are the owners of,
the land included within the division shown on
this map within the colored border lines and we consent
to the preparation and filing of said map and division.

David W. Tope
David W. Tope

Jimmy Tope
Jimmy Tope

State of California } S.S.
County of San Luis Obispo }

On this 18th day of August, 1980, before me,
the undersigned, a Notary Public in and for said County
and State personally appeared David W. Tope and Jimmy
Tope, known to me to be the persons whose names appear
on the within instrument, and acknowledged to me that
they executed the same.

Witness my Hand and Official Seal:

Berna J. Faltus
Notary Public.